

UConn Health Center – Main Building Farmington

Main Floor Classrooms

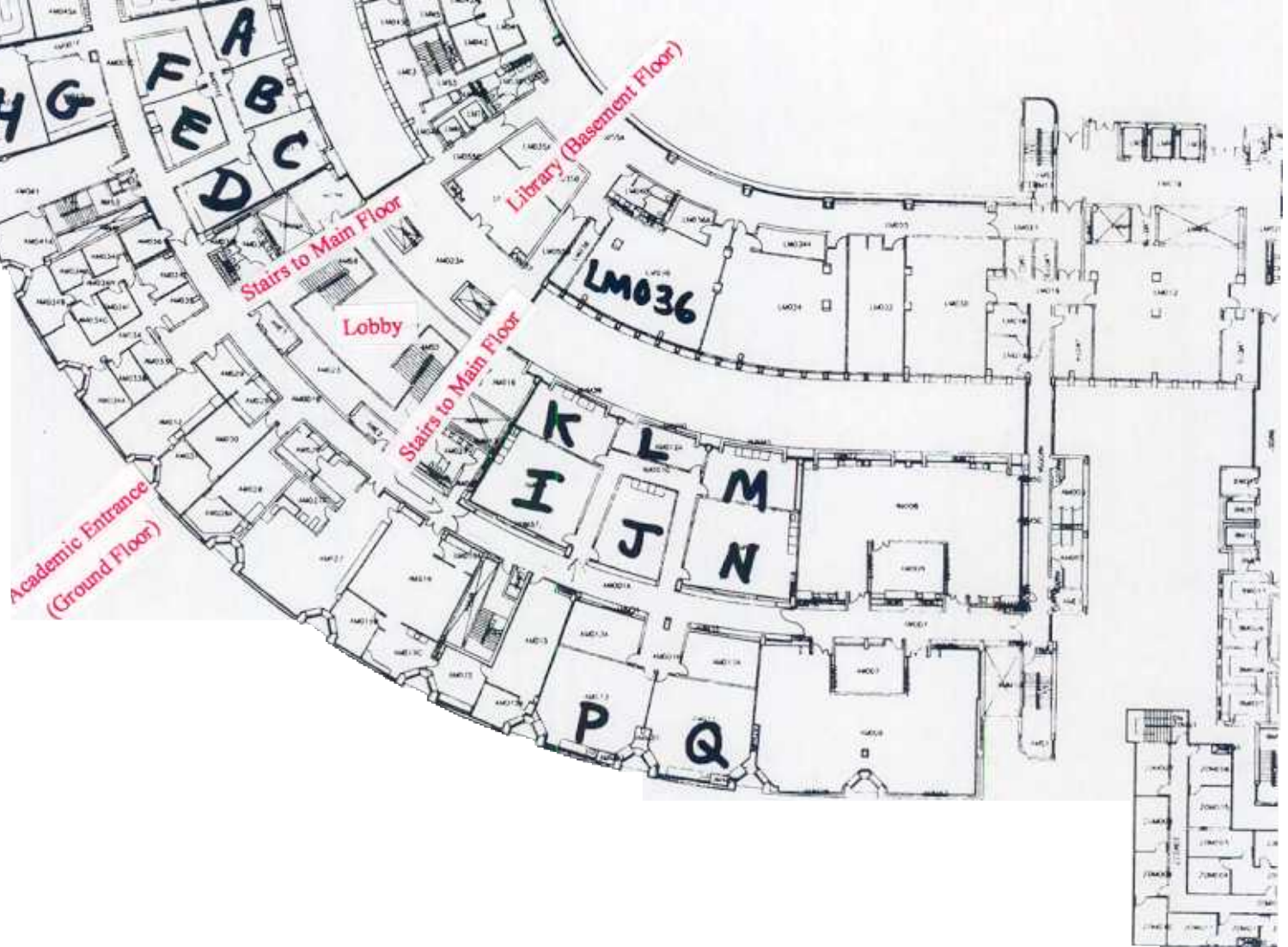

UConn Health Center – Main Building Farmington

Ground Floor Classrooms

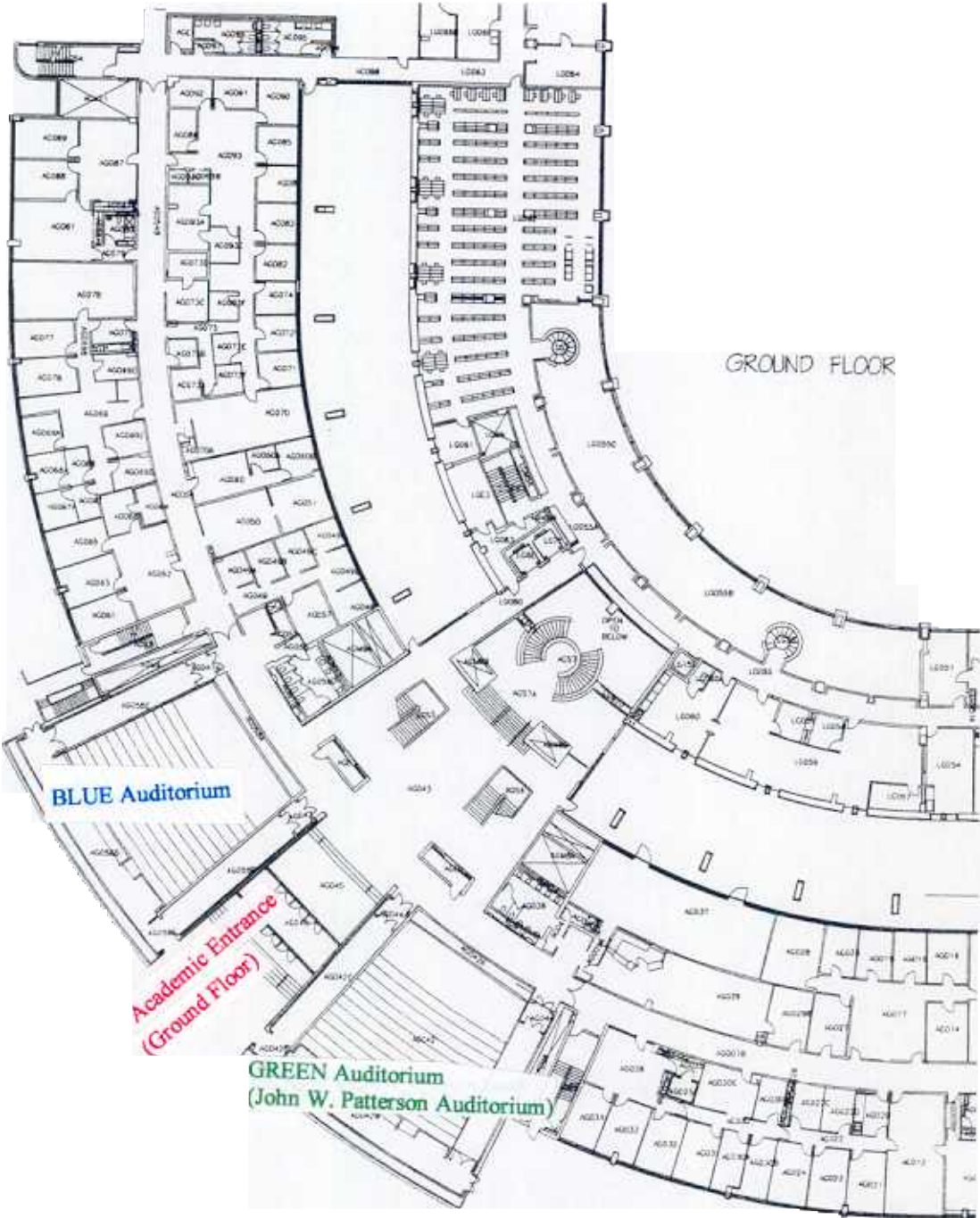

Administrative Services Building (ASB) Lower Campus – Farmington

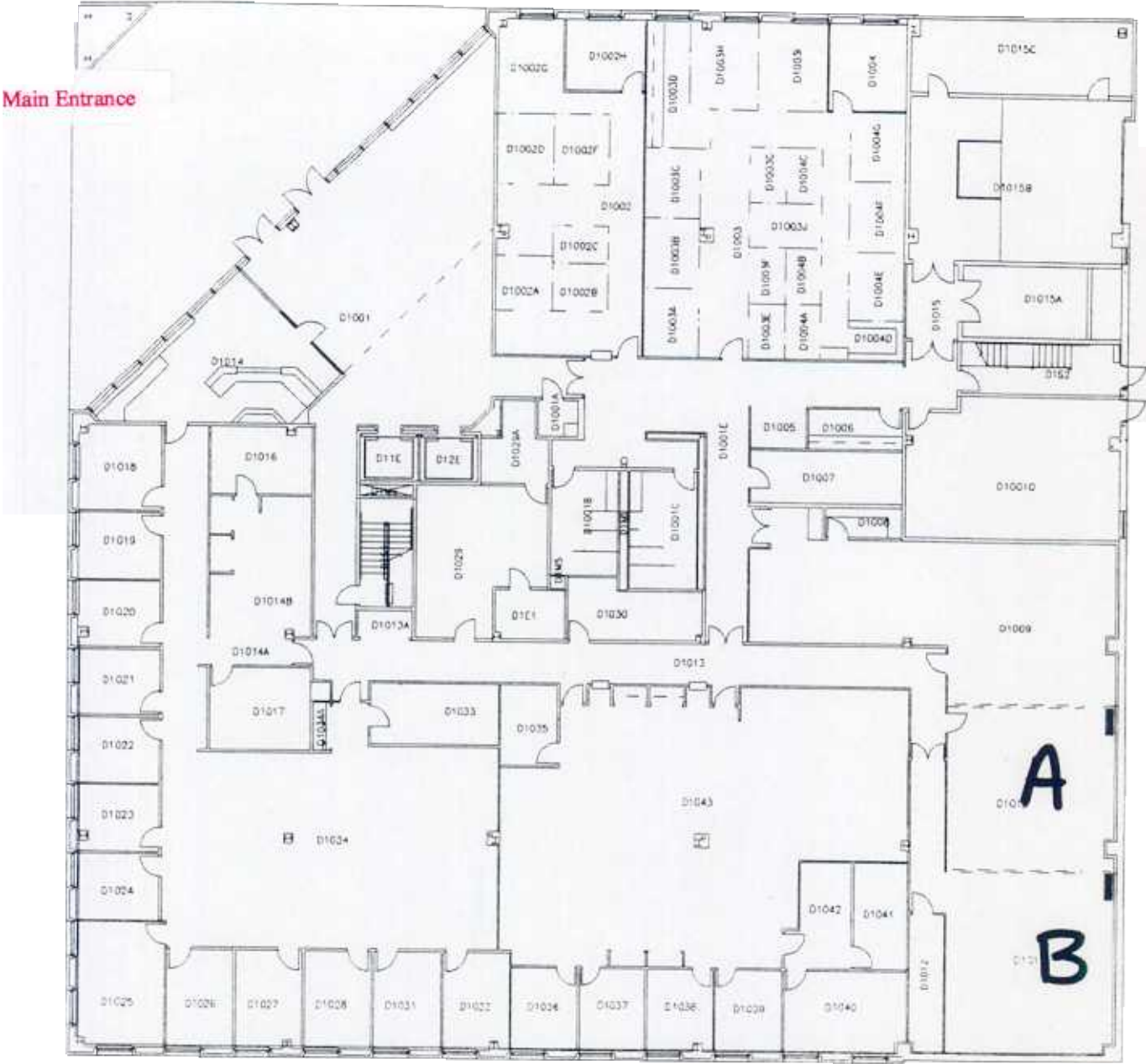

1st FLOOR

UCHC MPH CLASSROOM DIRECTIONS

All directions are from the academic parking lot and entrance unless otherwise noted.

ARB SEMINAR ROOM (LARGE) EG013

From the Academic Entrance (facing the Library) walk down the corridor on your right. The corridor will turn to the left - continue through the double doors at the end. You will be in the Police Dept. Lobby. Take the corridor on your right walking diagonally through the lobby and walk to the end of that hallway. This will bring you into the ARB lobby. The Conference Room is on the right. Signs will also be posted.

IF YOU ARRIVE AFTER 4:45 PM go into the academic parking lot on the upper right side of and closest to the academic building (Lots A & B) and follow to the new Research Building on the end. Enter the building and turn right; EG013 is immediately on your right.

ARB SEMINAR ROOM (SMALL) EG052

Follow the directions to EGO13. EG052 is the last room on the left.

BLUE AUDITORIUM

In the lobby of the academic entrance, turn left and enter the first door on your left.

CLASSROOMS A through F

From the academic entrance, proceed up the staircase on the left. At the top of stairs, go through the doorway and turn right. Pass the bulletin boards on your right and turn right at the sign "Classrooms A-F." Turn left, and classrooms A through F are on your right.

CLASSROOM G & H

From the academic entrance, proceed up the staircase on the left. At the top of stairs, go through the doorway and turn right. Proceed down the hallway, past the bulletin boards and a telephone on your left, and turn left. There is a sign on the wall for conference rooms

G & H; Classroom G is on the left and classroom H is straight ahead.

CLASSROOMS I through N and O through S

From the academic entrance, proceed up the staircase on the left. At the top of stairs, go through the doorway and turn left (in the opposite direction from the cafeteria). Proceed down the hallway, past the bulletin boards. There are signs for all the classrooms (N through S) and the rooms are located both on the left and right of the hallway.

COMMUNITY MEDICINE CONFERENCE ROOM AG070

From the academic entrance, turn left down the hallway; the room is on the right.

DENTAL DEAN'S CONFERENCE ROOM AG012

From the academic entrance, turn right down the hallway; the room is on your right.

DOWLING NORTH CONFERENCE ROOM

Entering the Health Center from Farmington Ave. (Route 4), take a right at the stop sign, go straight ahead, through another stop sign. Dowling North is straight ahead. The conference room is on the second floor.

Over please

GREEN AUDITORIUM – (John W. Patterson Auditorium)

In the lobby of the academic entrance, turn right. The Green Auditorium is on your right.

KELLER AUDITORIUM

Park by the Hospital Entrance. Enter the hospital lobby and about 100 feet ahead there is an escalator to your left. Go down one level and enter the Keller Lobby. The Keller Auditorium is straight ahead as you face the lobby.

LECTURE ROOM A AMO36

From the academic entrance, proceed up the staircase on the right. At the top of the stairs, turn left and continue down hall; AMO36 is the second room on the right.

LINKROOM

Park by the Hospital Entrance. Enter the hospital lobby and about 100 feet ahead there is an escalator to your left. Go down one level and through the Keller Lobby. Turn left down the hallway and the Link Room is on your left.

MEDICAL DEAN'S CONFERENCE ROOM AG078

From the academic entrance, turn left down the hallway; the room is on your left.

ASB BUILDING – CONFERENCE ROOM A & B

From the entrance on Farmington Ave., Go to the first 4- way stop sign. Turn left into the driveway of the ASB Building. Park in front. Enter the front entrance, turn left past main elevators and you will see signs for Conference room A & B.

If coming from the Academic Entrance of Health Center, go around the Health Center and back down the hill towards Farmington Ave. At the stop sign by the Helipad, turn right into the ASB Building parking lot. Park in front and follow directions above.